

PROGRAM

NATIONAL CONFERENCE

AUGUST 2-3, 2017 | HYATT REGENCY • BETHESDA, MARYLAND

Meeting Employer Demand in a Job-Driven Economy: Diversity, Inclusion, and VR's Evolving Role



Hosted by the Job-Driven Vocational Rehabilitation Technical Assistance Center (JD-VRTAC) and Vocational Rehabilitation Research and Training Center on Demand-Side Strategies (Demand-Side RRTC)



The JD-VRTAC and Demand-Side VR-RRTC have partnered to host this National Conference. The JD-VRTAC is funded by the Rehabilitation Services Administration (RSA) within the US Department of Education under grant #H264A140002. The Vocational Rehabilitation Research and Training Center on Demand-Side Strategies (Demand-Side RRTC) is funded by the National Institute on Disability, Independent Living, and Rehabilitation Research (NIDILRR) Grant # H133B120002. The JD-VRTAC and the Demand-RRTC are national centers housed at the Institute for Community Inclusion (ICI) at the University of Massachusetts Boston. The centers are part of ExploreVR, the data hub for a group of vocational rehabilitation research projects at ICI.

Explore VR
Informing Research, Policy, and Practice



WELCOME

Greetings!

Welcome to our conference: *Meeting Employer Demand in a Job-Driven Economy: Diversity, Inclusion, and VR's Evolving Role*. I'm looking forward to the two days we'll be spending together.

During the conference, we'll highlight the achievements of two national centers housed at the Institute for Community Inclusion: the Job-Driven Vocational Rehabilitation Technical Assistance Center (JD-VRTAC), and the Demand-Side Rehabilitation Research and Training Center (Demand-Side RRTC). We'll also look at successful job-driven research and practices from a variety of state VR and partner agencies in the field.

The ICI and our partners are dedicated to advancing the full inclusion of people with disabilities in their communities. As such, the JD-VRTAC and Demand-Side RRTC are key players in our mission. Over the next two days, you'll be learning more about what these two projects do, and how they fit in with your work in this field.

Thank you for joining us at this conference. I look forward to meeting you, and chatting about how we can work together to help shape the future of VR.



A handwritten signature in black ink, appearing to read 'Tom'.

Tom Sannicandro
Director, Institute for Community Inclusion
University of Massachusetts Boston



#ExploreVR

Let's continue our conversation about business and client needs in VR!

Share interesting information, new ideas, and helpful hints you learn on social media. Don't forget to include #ExploreVR with your tweets, photos and posts. And remember to follow

@ICInclusion
Facebook.com/



TABLE OF CONTENTS

Schedule At-A-Glance	3
Conference Schedule Day 1	4
Conference Schedule Day 2	7
Presenters	6
Floor Map of Hyatt Regency	8



9:00–9:20am

Welcome Regency Ballroom

9:20–10:20am

Opening Panel - How VR meets the needs of business and clients Regency Ballroom

SESSION 1: BUSINESS AS A CUSTOMER

10:25–11:05am

Research, Policy, and Practice..... Regency Ballroom

11:15am–12:00pm

Business Engagement at the National, State, and Local Levels..... Regency Ballroom

12:00–1:15pm

Lunch (on your own)

1:15–2:05pm

Breakout Sessions: Labor Market Information, Sector Strategies, and Community Rehabilitation Providers (CRPs)

How can VR use LMI in to engage business? Susquehanna/Severn

Sector Strategies.....Diploma/Ambassador

CRPs and Business Engagement Potomac/Patuyent

2:15–3:00pm

Business Panel - Business perspective on working relationships with VR..... Regency Ballroom

3:05–3:50pm

Work-based Learning Experiences—Starbucks in Maryland..... Regency Ballroom

4:00–5:00pm

Poster Session Regency Ballroom

LMI and the Demand Side RRTC Projects: Dashboards, Surveys, Interviews, and Sample Analysis

Apprenticeships

Internships and Business Partnerships

Customized Training Programs and Partnerships

The Progressive Employment Model Learning Collaborative

Career Pathways Projects

Assistive Technology Strategies with Business and Work-Based Learning

8:45–9:00am

Welcome Regency Ballroom

SESSION 2: ADVANCING HUMAN CAPITAL

9:00–9:35am

Job-Driven Training..... Regency Ballroom

9:40–10:25am

Demand-Side Research Findings on Business Relations..... Regency Ballroom

SESSION 3: YOUTH AND EARLY CAREER

10:40–11:20am

Business Engagement Strategies for Working with Youth..... Regency Ballroom

11:25am–12:15pm

Breakout Room Roundtables on Work-Based Learning for Youth

Roundtable 1: Youth-focused ApprenticeshipsDiploma/Ambassador

Roundtable 2: Youth-focused Internships..... Susquehanna/Severn

Roundtable 3: Youth-focused Customized Training Programs Potomac/Patuyent

9:00–9:20am

WELCOME REGENCY BALLROOM
Tom Sannicandro, Julisa Cully, and Cecilia Gandolfo, JD-VRTAC

9:20–10:20am

OPENING PANEL: HOW VR MEETS THE NEEDS OF BUSINESS AND CLIENTS..... REGENCY BALLROOM

Moderator: *DeBrittany Mitchell, JD-VRTAC & Demand-Side RRTC*

- *Dr. Susan Foley, Institute for Community Inclusion (ICI)*
- *Mark Schultz, Nebraska Vocational Rehabilitation*
- *Daniel Frye, New Jersey Commission for the Blind and Visually Impaired*
- *Emily Malsch, United States Business Leadership Network (USBLN)*

SESSION 1: BUSINESS AS A CUSTOMER

10:25–11:05am

GENERAL SESSION PANEL: RESEARCH, POLICY, AND PRACTICE..... REGENCY BALLROOM

Moderator: *Dr. Dana Jefferson, JD-VRTAC*

- **Research:** *Dr. Susan Foley, JD-VRTAC & Demand-Side RRTC*
- **Policy:** *Mary Wright, Jobs for the Future*
- **Practice:** *Kathy West-Evans, Council of State Administrators of Vocational Rehabilitation (CSAVR) National Employment Team (NET), JD-VRTAC & Demand-Side RRTC*

11:05–11:15am BREAK

11:15am–12:00pm

GENERAL SESSION PANEL: BUSINESS ENGAGEMENT AT THE NATIONAL, STATE, & LOCAL LEVELS..... REGENCY BALLROOM

Moderator: *Linda Mock, JD-VRTAC & Demand-Side RRTC*

- *Jeanne Miller, JD-VRTAC: Business engagement practices in the field*
- *Yvonne Wright, Missouri Vocational Rehabilitation: State-level business engagement and partnerships*
- *John Marchioro, Illinois Department of Rehabilitation Services: Regional business engagement and partnerships*
- *Morgan Rincon, Oregon Commission for the Blind: Engaging businesses statewide while ensuring blind and visually impaired individuals find competitive, integrated employment*

12:00–1:15pm LUNCH (ON YOUR OWN)

1:15–2:05pm

BREAKOUT SESSIONS: LABOR MARKET INFORMATION, SECTOR STRATEGIES, AND COMMUNITY REHABILITATION PROVIDERS (CRPS)

BREAKOUT ROOM: HOW CAN VR USE LMI TO ENGAGE BUSINESS? SUSQUEHANNA/SEVERN

Moderator: *Paula Pottenger, JD-VRTAC*

- *Amanda Gerson, New Jersey Commission for the Blind and Visually Impaired: Labor Market Information Training and Implementation*
- *Michael Quinn & Milton Moats, Alabama Department of Rehabilitation Services; Susan Foley, Demand-Side RRTC; May-Lorie Saint Laurent, JD-VRTAC & Demand-Side RRTC: The Creation, Implementation, and Challenges of Rolling Out an LMI Dashboard in Alabama and Preliminary Perspectives of Users*

BREAKOUT ROOM: SECTOR STRATEGIES..... DIPLOMAT/AMBASSADOR

Moderator: *Russ Thelin, JD-VRTAC*

- *Kartik Trivedi, JD-VRTAC & Demand-Side RRTC; Mark Schultz & Janet Drudik, Nebraska Vocational Rehabilitation: "On the Origin of Species": Evolution of Middle Skills Training by Natural Selection*
- *Steve Marshall, South Carolina Vocational Rehabilitation Department: How South Carolina VR uses sector strategies to serve the dual customer*
- *Jennifer Scilacci, Colorado Division of Vocational Rehabilitation: How Colorado VR uses sector strategies to serve the dual customer*

BREAKOUT ROOM: CRPS AND BUSINESS ENGAGEMENT POTOMAC/PATUYENT

Moderator: Laurie Ford, JD-VRTAC

- **Betsy Hopkins, Maine Division of Vocational Rehabilitation:**
How Maine DVR partners with CRPs to engage business
- **Shannon Myers: Iowa Department for the Blind:**
How Iowa Dept. for the Blind partners with CRPs to engage business

2:15–3:00pm

GENERAL SESSION PANEL: BUSINESS PANEL - BUSINESS PERSPECTIVE ON WORKING RELATIONSHIPS WITH VR REGENCY BALLROOM

Moderator: Kathy West-Evans, Council of State Administrators of Vocational Rehabilitation (CSAVR) National Employment Team (NET), JD-VRTAC & Demand-Side RRTC

- **Kathy Burris, Workforce Initiatives Manager, Focus Group Lead - Abilities and Abundance, CVSHealth**
- **TBD**

3:05–3:50pm

GENERAL SESSION PANEL: WORK-BASED LEARNING EXPERIENCES – STARBUCKS IN MARYLAND..... REGENCY BALLROOM

Moderator: Neil McNeil, JD-VRTAC & Demand-Side RRTC

- **Jim Evans, Jessica Hawes, Jonathan Barad, Khristopher Bailey - Maryland DORS**
- **Melanie Hood-Wilson, Community College of Baltimore County**
- **Aaron Thompson & Denise Jameson, Starbucks**

3:50–4:00pm BREAK

4:00–5:00pm

POSTER SESSION REGENCY BALLROOM

LMI and the Demand Side RRTC Projects: Dashboards, Surveys, Interviews, and Sample Analysis

- *Interactive demonstration of the ADRS LMI Dashboard* | **Michael Quinn and Milton Moats, Alabama Department of Rehabilitation Services**
- *Key survey findings from the Business Relations Survey* | **May-Lorie Saint Laurent, JD-VRTAC & Demand-Side RRTC**
- *Qualitative Interviews of VR counselors using LMI in Alabama* | **Melissa Alford, Demand-Side RRTC**
- *LMI Catalog: Using LMI in VR* | **Kartik Trivedi & May-Lorie Saint Laurent, JD-VRTAC & Demand-Side RRTC**
- *LMI & the JD-VRTAC: Integrating LMI into VR Practice at the Connecticut Bureau of Education & Services for the Blind* | **Jonathan Richmond, Connecticut Bureau of Education and Services for the Blind**

Apprenticeships

- *Apprenticeship programs with Arkansas VR* | **Jonathan Bibb, Arkansas Rehabilitation Services**
- *Apprenticeship Programs and Disability* | **Tom Hooper, Jobs for the Future, JD-VRTAC**

Internships and Business Partnerships

- *Internships and VR Business Partnerships* | **Mary Ofiato & Joey Buizon, Massachusetts Commission for the Blind**
- *USBLN Mentoring Program* | **Keri Gray, USBLN**
- *Pennsylvania's Training Program with Starbucks* | **Ralph Roach, Pennsylvania Office of Vocational Rehabilitation**

Customized Training Programs and Partnerships

- *Customized Training Partnerships with Business and the technical college system* | **Steve Marshall, South Carolina Vocational Rehabilitation Department**
- *Customized Training Partnerships with Deltech* | **Ashley Kavanagh, Delaware Division of Vocational Rehabilitation**
- *Partnership Training Programs with VR* | **Melanie Hood-Wilson, Community College of Baltimore County**
- *Customized Training Partnerships with Business* | **Jim Evans, Maryland Department of Rehabilitation Services**
- *Middle Skills Training Program in Healthcare* | **Kartik Trivedi, JD-VRTAC & Demand Side RRTC**

The Progressive Employment Model Learning Collaborative

- *Progressive Employment Research Findings (Progressive Employment vs. Business as usual):* **Susan Foley & Dennis Moore, Demand-Side RRTC**
- *Progressive Employment Video Series:* **DeBrittany Mitchell, JD-VRTAC & Demand-Side RRTC**
- **Hugh Bradshaw, Vermont Vocational Rehabilitation**
- **Libby Stone-Sterling, Maine Division of Vocational Rehabilitation**
- **Morgan Rincon, Oregon Commission for the Blind**
- **Mark Shultz, Nebraska Vocational Rehabilitation**

Career Pathways

- *Advanced Manufacturing Supplement Career Pathways*
Tish Harris, Virginia Department for the Blind and Visually Impaired
- *UpSkill/Backfill Model Career Pathways Project*
Janet Drudik, Nebraska Vocational Rehabilitation
- *Job-Driven Career Lattices Project*
Ashley Kavanagh, Delaware Division of Vocational Rehabilitation

Assistive Technology Strategies with Business and Work-Based Learning

- **Mary Otiato & Joey Buizon, Massachusetts Commission for the Blind**
- **Amanda Gerson, New Jersey Commission for the Blind and Visually Impaired**
- **Jason Clary, Oregon Commission for the Blind**
- **Kevin Markel, Texas Workforce Commission - Blind Services Division**

5:00pm

ADJOURN

PRESENTERS

MELISSA ALFORD

Research Study Coordinator
Institute for Community Inclusion
Demand-Side RRTC

JONATHAN BIBB

Director of Arkansas Career and
Training Institute
Arkansas Rehabilitation Services

HUGH BRADSHAW

Employment Services Manager
Vermont Vocational Rehabilitation
Demand-Side RRTC

JOEY BUIZON

Supervisor of Employment Services
Massachusetts Commission for the
Blind

KATHY BURRIS

Workforce Initiatives Manager
Focus Group Lead
Abilities and Abundance
CVSHealth

JASON CLARY

Director of Orientation and Career
Center
Oregon Commission for the Blind

JANET DRUDIK

Program Director
Nebraska Vocational Rehabilitation

JIM EVANS

Assistant Director at the Workforce &
Technology Center
Maryland Division of Rehabilitation
Services

JOHN FICCA

Director
Hands on Education

DR. SUSAN FOLEY

Senior Research Fellow
Institute for Community Inclusion
Demand-Side RRTC

DANIEL FRYE

Executive Director
New Jersey Commission for the Blind
and Visually Impaired

AMANDA GERSON

Coordinator of Vocational
Rehabilitation and Transition Services
New Jersey Commission for the Blind
and Visually Impaired

KERI GRAY

Program Manager
Rising Leaders Initiatives
United States Business Leadership
Network

TISH HARRIS

Career Pathways for Individuals with
Disabilities Project Coordinator
Virginia Department for the Blind and
Visually Impaired

JESSICA HAWES

Employment Specialist Supervisor
Maryland Department of
Rehabilitation Services Workforce
and Technology Center

MELANIE HOOD-WILSON

Program Director
Community College of Baltimore
County

TOM HOOPER

Associate Vice President
Jobs for the Future
JD-VRTAC

BETSY HOPKINS

Director
Maine Division of Vocational
Rehabilitation

ASHLEY KAVANAGH

Social Services Administrator
Delaware Division of Vocational
Rehabilitation

JOCELYN LANGREHR

Deputy Director
Delaware Division of Vocational
Rehabilitation

EMILY MALSCH

Sourcing and Community Outreach
Consultant
Going for the Gold Program
United States Business Leadership
Network

JOHN MARCHIORO

Director of Training
Illinois Department of Rehabilitation
Services

KEVIN MARKEL

Transition Program Specialist
Texas Workforce Commission - Blind
Services Division

JOE MARRONE

Senior Program Manager of Public
Policy
Institute for Community Inclusion
JD-VRTAC

STEVE MARSHALL

Business Services Coordinator
South Carolina Vocational
Rehabilitation Department

JEANNE MILLER

University of Arkansas
CURRENTS
JD-VRTAC

DEBRITANY MITCHELL

Knowledge Translation Associate
Institute for Community Inclusion
JD-VRTAC & Demand-Side RRTC

MILTON MOATS

Rehabilitation Specialist
Alabama Department of
Rehabilitation Services
Demand-Side RRTC

LINDA MOCK

Senior Policy Fellow and Program
Specialist
Institute for Community Inclusion
JD-VRTAC & Demand-Side RRTC

DR. DENNIS MOORE

Professor Emeritus Population &
Public Health
Wright State University
Consultant, Demand-Side RRTC

SHANNON MYERS

Employment Specialist
Iowa Department for the Blind

KIM OSMANI

Transition Coordinator
Oklahoma Department of
Rehabilitation Services

MARY OTIATO

Chief of Staff and Director of Policy
Massachusetts Commission for the
Blind

MICHAEL QUINN

Program Evaluation Coordinator and
Functional Business Intelligence Lead
Alabama Dept of Rehabilitation
Services
Demand-Side RRTC

JONATHAN RICHMOND

Vocational Rehabilitation Counselor
Coordinator
CTBureau of Education and Blind
Services

MORGAN RINCON

Business Relations Coordinator
Oregon Commission for the Blind

RALPH ROACH

Business Services and Outreach
Division Chief
Pennsylvania Office of Vocational
Rehabilitation

MAY-LORIE SAINT LAURENT

Research Study Coordinator
Institute for Community Inclusion
JD-VRTAC & Demand-Side RRTC

MARK SCHULTZ

Deputy Commissioner
Nebraska Vocational Rehabilitation
Demand-Side RRTC

JENNIFER SCILACCI

Business Outreach Team and
Self-Employment and Supported
Employment Programs Manager
Colorado Division of Vocational
Rehabilitation

LIBBY STONE-STERLING

Assistant Director
Maine Division of Vocational
Rehabilitation

KARTIK TRIVEDI

Research Associate
Institute for Community Inclusion
JD-VRTAC & Demand-Side RRTC

KATHY WEST-EVANS

Council of State Administrators of
Vocational Rehabilitation (CSAVR)
National Employment Team (NET),
JD-VRTAC & Demand-Side RRTC

MARY WRIGHT

Director, Employer Alliances
Jobs for the Future
JD-VRTAC

YVONNE WRIGHT

Director of Workforce Development
and Business Outreach
Missouri Vocational Rehabilitation

8:45–9:00am

WELCOME REGENCY BALLROOM

Julisa Cully and Cecilia Gandolfo, JD-VRTAC

SESSION 2: ADVANCING HUMAN CAPITAL

9:00–9:35am

GENERAL SESSION PANEL: JOB-DRIVEN TRAINING REGENCY BALLROOM

Moderator: *Cecilia Gandolfo, JD-VRTAC*

- *VR: Training from the VR Perspective*
Joe Marrone, JD-VRTAC
- *Business: Training from the Vendor & Business Perspective*
John Ficca, Hands on Education Services
Lori Nairne, HR Director at Grand Hyatt Washington

9:40–10:25am

GENERAL SESSION PANEL: DEMAND-SIDE RESEARCH FINDINGS ON BUSINESS RELATIONS REGENCY BALLROOM

Moderator: *Kartik Trivedi, JD-VRTAC & Demand-Side RRTC*

- *Vermont Progressive Employment: Model Replication and Evaluation:*
Dennis Moore, Demand-Side RRTC; Hugh Bradshaw, Vermont Vocational Rehabilitation
- *VR and Business Relations: National Survey*
Kathy West Evans, May-Lorie Saint Laurent, and Melissa Alford, Demand-Side RRTC
Linda Mock, JD-VRTAC & Demand-Side RRTC

10:25–10:40am BREAK

SESSION 3: YOUTH AND EARLY CAREER

10:40–11:20am

GENERAL SESSION PANEL: BUSINESS ENGAGEMENT STRATEGIES FOR WORKING WITH YOUTH REGENCY BALLROOM

Moderator: *Joe Marrone, JD-VRTAC & Demand-Side RRTC*

- *Progressive Employment and Work-Based Learning with Jobs for Maine's Graduates:*
Betsy Hopkins and Libby Stone-Sterling, Maine Division of Vocational Rehabilitation
- *Engaging business to Hire Minors:*
Ralph Roach, Pennsylvania Office of Vocational Rehabilitation

11:25am–12:15pm

BREAKOUT ROOM ROUNDTABLES ON WORK-BASED LEARNING FOR YOUTH

ROUNDTABLE 1: YOUTH-FOCUSED APPRENTICESHIPS DIPLOMAT/AMBASSADOR

Facilitator: *Jeanne Miller, JD-VRTAC*

- *Steve Marshall, South Carolina Vocational Rehabilitation Department*
- *Kim Osmani, Oklahoma Department of Rehabilitation Services*

ROUNDTABLE 2: YOUTH-FOCUSED INTERNSHIPS SUSQUEHANNA/SEVERN

Facilitator: *Vito DeSantis, JD-VRTAC & Demand-Side RRTC*

- *Joey Buizon & Mary Otiato, Massachusetts Commission for the Blind*

ROUNDTABLE 3: YOUTH-FOCUSED CUSTOMIZED TRAINING PROGRAMS POTOMAC/PATUYENT

Facilitator: *Mary Ann Bedick, JD-VRTAC*

- *Jocelyn Langrehr & Ashley Kavanagh, Delaware Division of Vocational Rehabilitation*

12:20–12:40pm

FINAL REMARKS AND ADJOURN REGENCY BALLROOM

CONFERENCE LEVEL

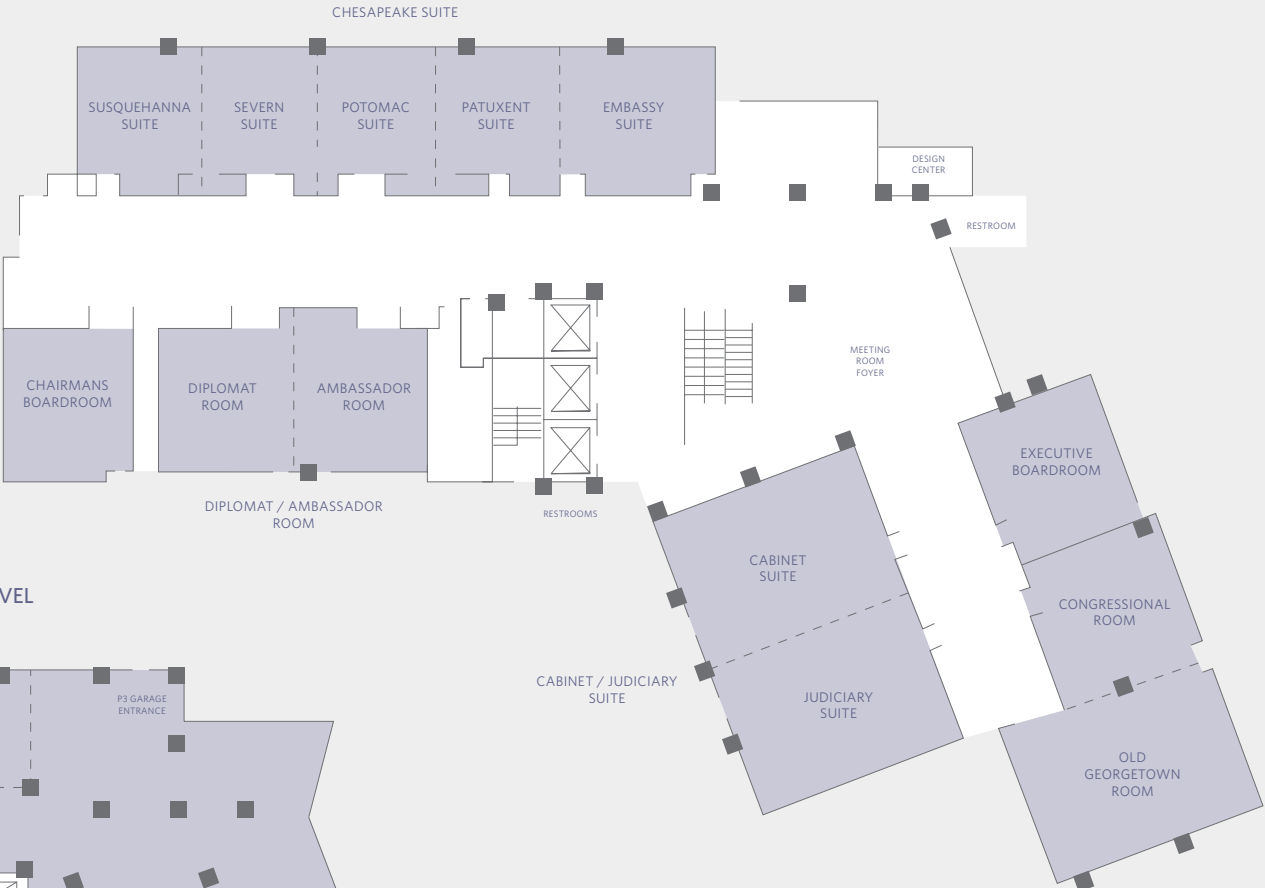

BALLROOM LEVEL

